

Catalog #		Type
Project		
Description		Date

BOLLARD

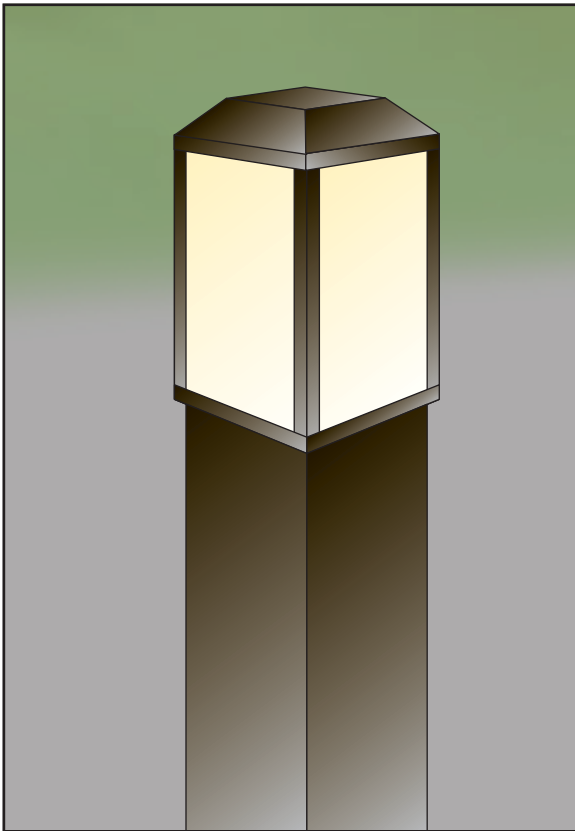

BOLLARD 60 SERIES

Standard Features

Material
Paintlok sheet; Standard Powdercoat Finish,
White Acrylic Lens; .125 thickness,
ETL Wet Location.

Installation
Mounting/wireway hole in center of Mounting Plate.

Optics*
Contact Evergreen Lighting for complete
photometrics.

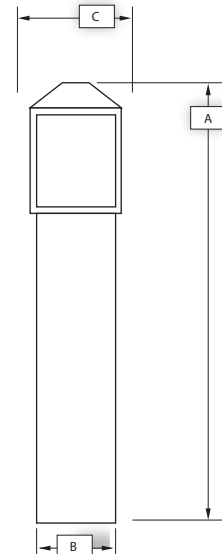

LED Features

LED
Alta LED #AL-R-1W-30LED array to be
mounted onto an Aluminum MPCB Board
configured to the proper wattage. The LED
arrays will be centered within the Lens area and
mounted on a white aluminum reflective plate.

Driver

Specific Drivers will be matched with each
different LED array configuration/wattage.
Standard Driver Features:

- Constant Current
- 3 / 5 year warranty
- 120/277 multi-voltage power supplies
- Kelvin - 2700K, 3000K, 3500K, 4100K, 5000K

Fluorescent Features

Ballast
SC programmed electronic high power
factor ballast, multivoltage 120V/277V.
Lamps not included

Finishes

Ballast

Architectural Bronze (AB)	Textured Gold (TG)
Textured Bronze (TBR)	Metallic Nickel (MN)
Matte Black (MBK)	Textured Verde Patina (TVP)
Semi Gloss Black (GBK)	Satin Brass (SB)
Textured Black (TBK)	Copper Vein (CV)
Textured Rust (TR)	Gold Vein (GV)
Matte White (MW)	Silver Vein (SV)
Textured White (TW)	Chrome (CH)
Gloss White (GW)	Oil Rubbed Bronze (ORB)
Metallic Grey (MG)	

Options*

Emergency (EMR)	Special Lens
Photocell (PC)	Incandescent
Lamp Sources	
Size Modifications	
Vandal Proof Enclosure (VPE)	

Sample Spec Number: B60602A-AB-07-120

Part #	Wattage	Lumens	(A)	Width(B)	Fix. Width(C)
B60602A	100A	--	32"	6"	6-3/4"
B60603F	13Q	800	32"	6"	6-3/4"
B60604F	(2) 13Q	1600	32"	6"	6-3/4"
B60605F	QUAD26	1800	32"	6"	6-3/4"
B60611F	F32TBX	2200	32"	6"	6-3/4"
B60622F	F42TBX	3200	32"	6"	6-3/4"
B60650H	50HPS	4000	42"	8"	9"
B60670H	70HPS	6400	42"	8"	9"
B606100H	100HPS	9500	42"	8"	9"
B60650M	50MH		42"	8"	9"
B60670M	70MH	5500	42"	8"	9"
B606100M	100MH	9000	42"	8"	9"
B60612L-32"	12LED	1200	32"	6"	6 3/4"
B60618L-32"	18LED	1800	32"	6"	6 3/4"
B60624L-32"	24LED	2400	32"	6"	6 3/4"
B60618L-42"	18LED	1800	42"	8"	9"
B60628L-42"	28LED	2800	42"	8"	9"
B60636L-42"	36LED	3600	42"	8"	9"

