

The Venus Series

EVERGREEN LIGHTING CORPORATION



The Venus Series features round or square aluminum bollards with cast aluminum louvers.

HOUSING – Round or square extruded aluminum, offered in 8", 10", and 12" standard sizes. The standard height is 42".

LOUVERS – Rugged cast aluminum external louvers 360° around the bollard. Available 180° louvers are illustrated in the Options table.

LENS – The standard lens is 3/8" thick, clear, UV-stabilized high-impact resistant acrylic. It is rabbeted for flush fit, and silicone sealant creates a tight gasketing.

OPTICS – Available "house side" cut-off shield; please see the Options table.

SOCKET – HID sockets are glazed porcelain, medium base, rated to 600V. Fluorescent sockets are standard PL-type.

ELECTRICAL COMPONENTS – Available in LED, MH and fluorescent. All ballasts are CWA/HPF regulating auto-transformers. The starting temperature for LED is -40°F, and MH starts at -20°F. Maximum wattage is 36W LED, 175W MH, and

**ETL & CSA LISTED FOR WET LOCATIONS.
FACTORY TESTED BEFORE SHIPMENT.**

42W PL fluorescent. Fluorescent is available in 120V or 277V only.

TOP CAP – The top cap is spun, cast, die-formed or extruded from heavy-gauge aluminum. Four shapes are available:

- flat top, for round or square Venus bollards (see photos center and right, above).
- dome top, for round Venus bollards (see photo above left).
- pyramid top, for square Venus bollards.
- radiused top, for square Venus bollards (see photo on page 18, right).

ANCHOR BASE AND BOLTS – Three (3) 3/8" x 12" galvanized anchor bolts are supplied, complete with two each nuts and washers. The anchor base plate is made of heavy-duty aluminum.

FINISH – The finish is thermoset polyester oven-baked powder coat, in any standard Evergreen Lighting Custom colors are available to your specifications; consult factory.

EVERGREEN LIGHTING MANUFACTURERS OF QUALITY LIGHTING EQUIPMENT

1379 RIDGEWAY STREET, POMONA, CA 91768

voice: **909/865-5599** fax: **909/865-5539**

email: sales@evergreenlighting.com visit us online at: www.evergreenlighting.com



©2003, EVERGREEN LIGHTING CORP.

The Venus Series

| | | | | | | | |
|----------------|-------------|---------------|--------------|-------------|----------------|--------------|----------------|
| | 1 | 2 | 3 | 4 | 5 | 6 | 7 |
| FIXTURE | SIZE | SOURCE | VOLTS | LAMP | TOP CAP | COLOR | OPTIONS |
| VEN | 11 | H2 | 4 | L | 4 | WH | MT, TP |

Create a catalog number from the tables below. Example number: VEN – 11 – H2 – 4 – L – 4 – WH – MT, TP

1 SIZE

| | Shape | A | B | Max. Watts |
|-----------|--------|-----|--------------|------------------|
| Size = 10 | Round | 42" | 8" diameter | 100W |
| Size = 11 | Square | 42" | 8" x 8" | 100W |
| Size = 20 | Round | 42" | 10" diameter | 36W LED, 175W MH |
| Size = 21 | Square | 42" | 10" x 10" | 36W LED, 175W MH |
| Size = 30 | Round | 42" | 12" diameter | 36W LED, 175W MH |
| Size = 31 | Square | 42" | 12" x 12" | 36W LED, 175W MH |
| Size = 40 | * | * | | |

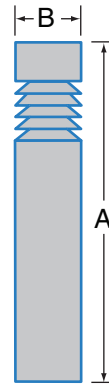

* custom: please specify

ALL SIZES
MAXIMUM FLUORESCENT
WATTAGE IS 42W

2 LIGHT SOURCE

| | LED | MH |
|------|-----|----|
| 12W | L12 | |
| 24W | L24 | |
| 36W | L36 | |
| 70W | | E2 |
| 100W | | H2 |
| 150W | | J2 |
| 175W | | K2 |

FLUORESCENT
X = single PL Y = dual PL
(specify wattage up to
single 42W or dual 13W)

4 LAMP

L = with lamp
N = no lamp

3 VOLTAGE

120V = 2
208V = 0
240V = 4
277V = 7

Also available in Multi-Tap:
see Options table

480V = 8 Not available in Multi-Tap

NOTE: FLUORESCENT SOURCES AVAILABLE IN
120V OR 277V ONLY.

5 TOP CAP

- 1 = Flat top cap (all sizes)
- 2 = Dome top cap (not available for sizes 11, 21, or 31)
- 3 = Pyramid top cap (not available for sizes 10, 20, or 30)
- 4 = Radiused top cap (not available for sizes 10, 20, or 30)

6 COLOR

| | |
|------------------|-------------------|
| BK = Black | GY = Gray |
| GR = Green | BU = Blue |
| WH = White | VP = Verde Patina |
| DB = Dark Bronze | CC = Custom color |
| SL = Silver | |

7 OPTIONS

MT = multi-tap transformer
QR = quartz restrike
PC = photo cell
PL = polycarbonate lens
HL = 180° louvers (illustrated at right)
LS = "house side" cut-off light shield
LV = contrasting color louvers; specify color
TP = tamper-proof hardware
FV = international ballast;
specify cycles



EVERGREEN LIGHTING CORPORATION